

**Viti a testa svasata con calotta ed impronta a croce**  
**Cross recess countersunk raised head screws**

**DIN 966**

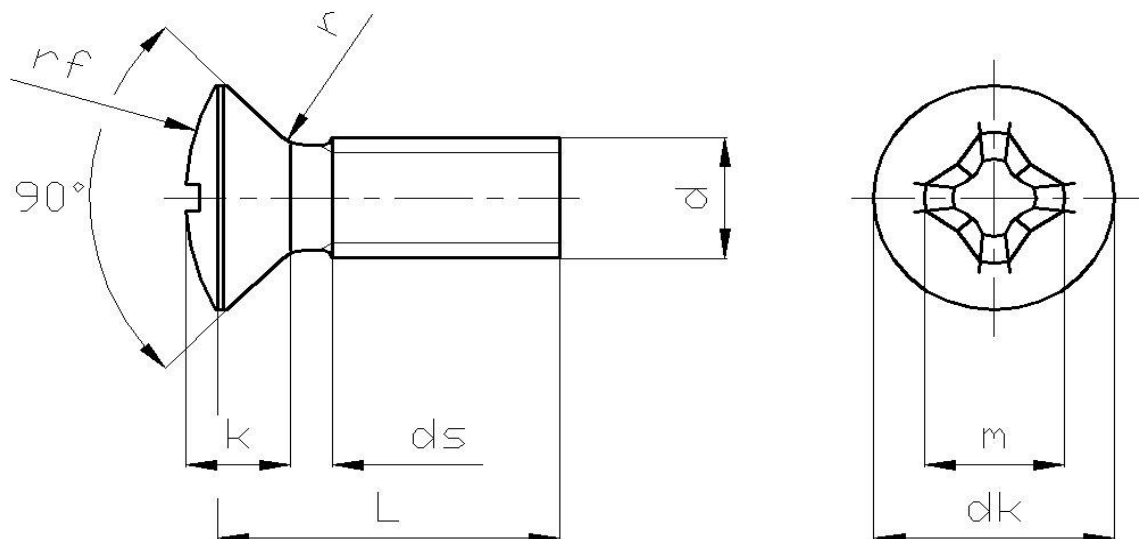

Diametro		M3	M4	M5	M6	M8
<b>P</b>	passo	0,5	0,7	0,8	1,0	1,25
<b>ds</b>	max	1,0	1,4	1,6	2,0	2,5
<b>b (d medio)</b>	rif	19	22	25	28	34
<b>dk</b>	max	<b>5,60</b>	<b>7,50</b>	<b>9,20</b>	<b>11,00</b>	<b>14,50</b>
	min	<b>5,30</b>	<b>7,14</b>	<b>8,84</b>	<b>10,57</b>	<b>14,07</b>
<b>k</b>	max	-	<b>2,80</b>	<b>3,30</b>	-	-
<b>r</b>	max	0,8	1,0	1,3	1,6	2,0
<b>rf</b>	≈	6	8	10	12	16
<b>m</b>	≈	3,1	4,5	5,3	6,8	9,0
<b>PHILLIPS</b>	t max	<b>2,00</b>	<b>2,54</b>	<b>3,27</b>	<b>3,53</b>	<b>4,68</b>
	t min	<b>1,70</b>	<b>2,04</b>	<b>2,77</b>	<b>3,03</b>	<b>4,18</b>
<b>POZIDRV</b>	m ≈	3,1	4,6	5,3	7,0	8,8
	t max	<b>2,08</b>	<b>2,72</b>	<b>3,35</b>	<b>3,76</b>	<b>4,52</b>
	t min	<b>1,83</b>	<b>2,26</b>	<b>2,89</b>	<b>3,30</b>	<b>4,06</b>